

REVISIONS	BY
	CJL

**CORNERSTONE**  
 DESIGN • ENGINEERING • CONSTRUCTION  
 403 B PENINSULA DRIVE, LAKE ALMANOR, CA. (530) 596-4333

A NEW RESORT  
**BREAKWATER COVE**  
 316 PENINSULA DR. LAKE ALMANOR, CA.

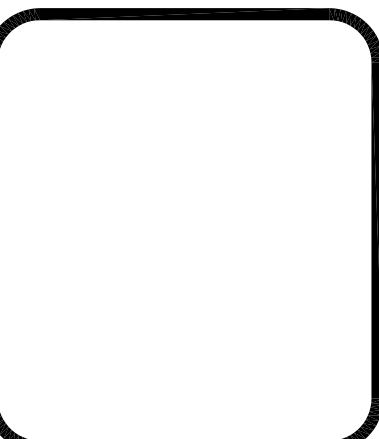

DRAWN	MDS
DESIGNED BY	CJL
DATE	7/22/05
SCALE	1/4" = 1'-0"
JOB NO.	00
SHEET	A2
OF ... SHEETS	

WALL SCHEDULE	
	2x6 EXTERIOR
	2x4 INTERIOR
	2x4 EXTERIOR
	2x8 SOUND WALL

- ① WATER-PROOF DECKING  
DEX-O-TEX OR APPROVED EQ.
- ② 36" HIGH WALL
- ③ MECHANICAL VENT DOOR
- ④ 3'-0" MECHANICAL DOOR  
ABOVE W/ COLD AIR RETURN  
BELOW
- ⑤ ROCK VENEER
- ⑥ 6x6 WRAPPED IN 1X CEDAR
- ⑦ STONE PILLAR
- ⑧ STAMPED & COLORED CONC.  
W/ SLATE APPEARANCE
- ⑨ 1" LIP EXTERIOR  
TO INTERIOR
- ⑩ 4x12 DECKING
- ⑪ TILE OR SLATE TO BE  
DETERMINED BY OWNER
- ⑫ CARPET
- ⑬ 3" FLOOR DRAIN

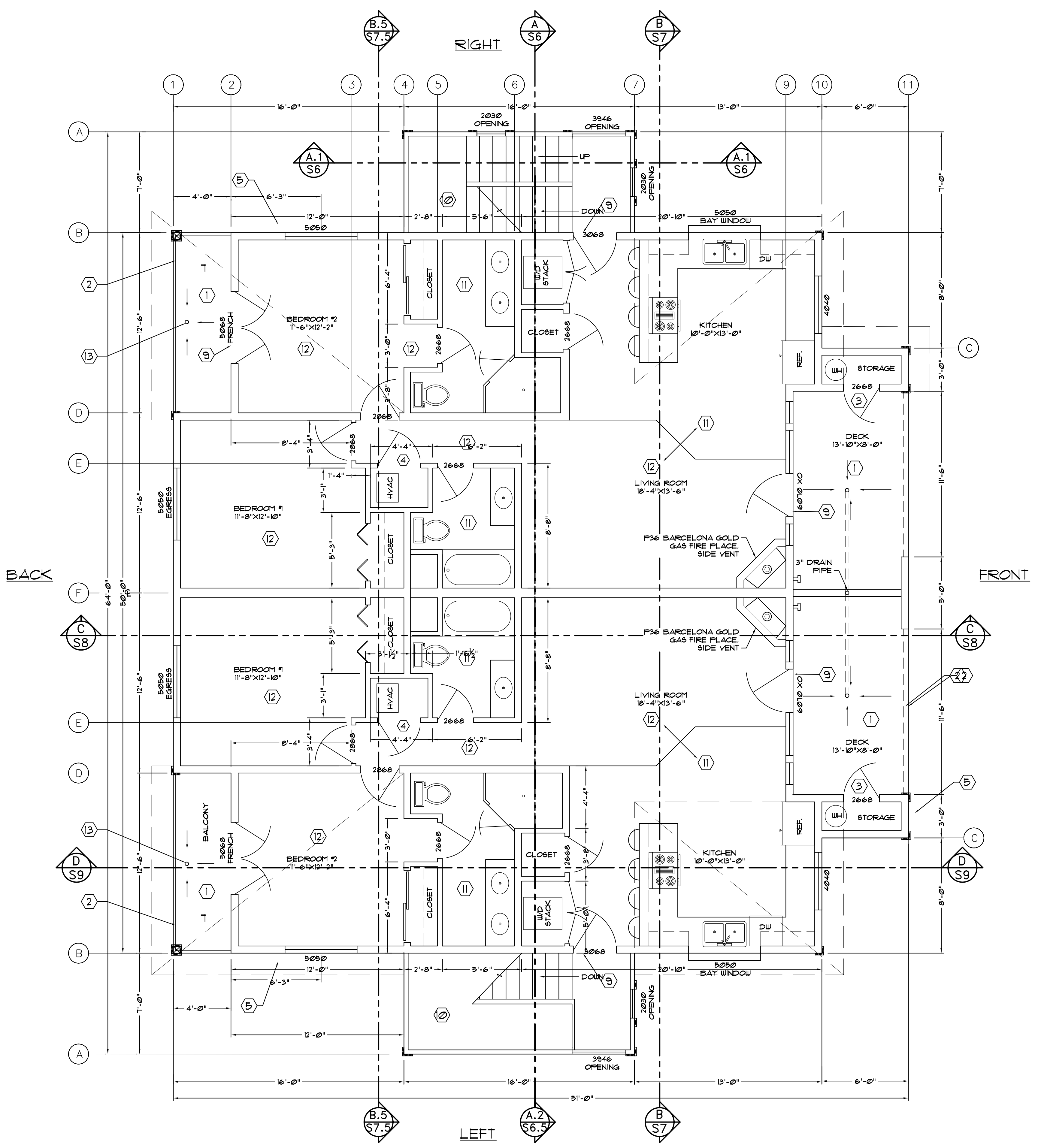

**SECOND FLOOR PLAN**  
 SCALE: 1/4" = 1'-0"  
 1041 S.F. PER UNIT

© CHRISTOPHER J. LUNA - ENGINEER  
 THESE DOCUMENTS AND THEIR CONTENTS ARE THE PROPERTY OF CHRISTOPHER J. LUNA - ENGINEER, AND ARE TO BE USED FOR THIS PROJECT ONLY. ANY CHANGES TO THESE PLANS, REGARDLESS OF HOW MINOR, WITHOUT THE WRITTEN APPROVAL OF CHRISTOPHER J. LUNA - ENGINEER, OR ANY CONSTRUCTION EXECUTED FROM THESE PLANS WITHOUT REVIEW AND APPROVAL OF ALL HARDWARE AND MATERIALS, OR ANY CHANGE OF SCOPE, DESIGN OR INTENT FOR ANY REASON, BY ANY PERSON OTHER THAN CHRISTOPHER J. LUNA - ENGINEER SHALL AUTOMATICALLY RENDER CHRISTOPHER J. LUNA - ENGINEER HARMLESS TO ANY LIABILITY CLAIMS, SUITS OR LITIGATION BY ANY INTERESTED PARTIES IN THE PROJECT. SPECIFICATIONS MAY ACCOMPANY THESE PLANS AND SHOULD BE READ CAREFULLY FOR ADDITIONAL CONDITIONS.